

FAST



**FAST TRACK TANK GEN 4B
INSTALLATION AND PARTS MANUAL**

8295RT, 8320RT, 8345RT

8310RT, 8335RT, 8360RT

8320RT, 8345RT, 8370RT

Fast Distributing, Inc.

54859 County Road 44

Mountain Lake, MN 56159

General Information

All rights, especially copying and distribution rights are reserved. No part of this publication may be reproduced in any form or by any means, electronic or mechanical, including photocopying, without express written permission from Fast Distributing, Inc.

Parts information in this manual represents components installed when product was manufactured based upon the best available information. Modifications made subsequent to initial delivery are not included. Always verify the parts and color required with Fast Distributing, Inc at 1-800-772-9279.

If you have any questions, please contact your dealer or our Parts and Service Department.

Contents

General Information.....	2
Remove Hydraulic Filter Cover, Step Assembly And Tool Box	4
Remove Center Link Bracket And Radar	5
Install Rear Tank Supports.....	5
Install Receiver Mounting Brackets	6
Install Setscrews.....	6
Install Radar	7
Install Tanks	8
Install Straps And Nylon Protector	10
Install Windshield Washer Reservoir And DEF Fill Bracket	10
Install Step Assembly	11
Tanks And Hardware	12
Plumbing.....	14

Remove Hydraulic Filter Cover, Step Assembly And Tool Box

1. Remove hydraulic filter cover (1) and set aside. Cover will not be re-installed with tanks installed on tractor.

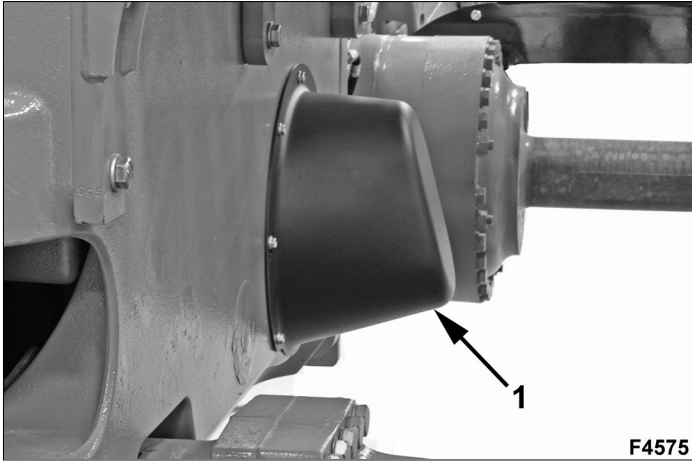

2. Remove hardware from windshield reservoir (2), mounting bracket and railing so reservoir can be moved out of the way. Save all hardware to be reused.

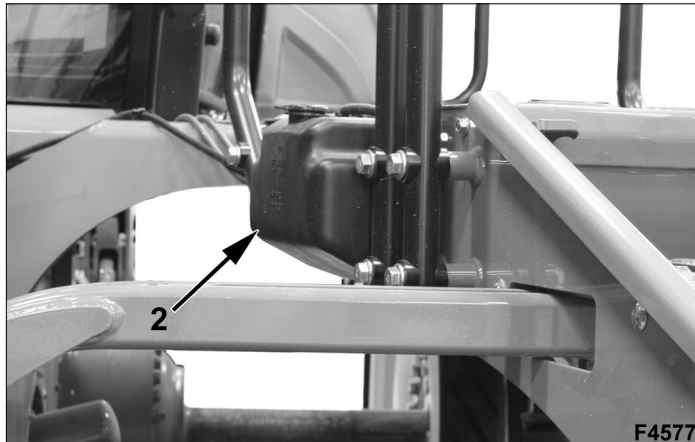

3. Tractor with DEF Fill only, Remove hardware from DEF fill bracket and save for reuse.



⚠ WARNING

Step assembly weighs approximately 300 lbs. Use an appropriate lifting device to prevent injury.

4. Attach lifting device to step assembly.
5. Remove nuts, washers and carriage bolts (4), (5) and (6). Save nuts, washers and carriage bolts (5) for reuse.

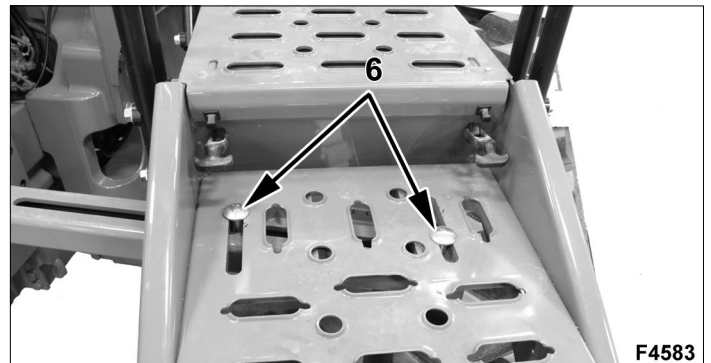
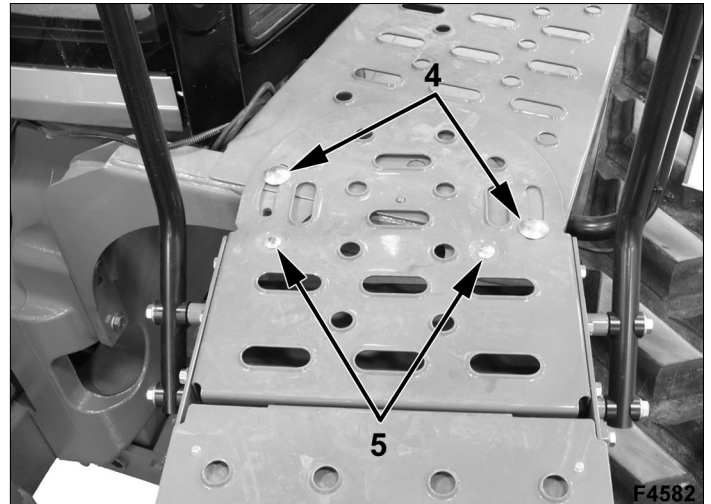

6. Remove step assembly.
7. Remove step bracket (7).

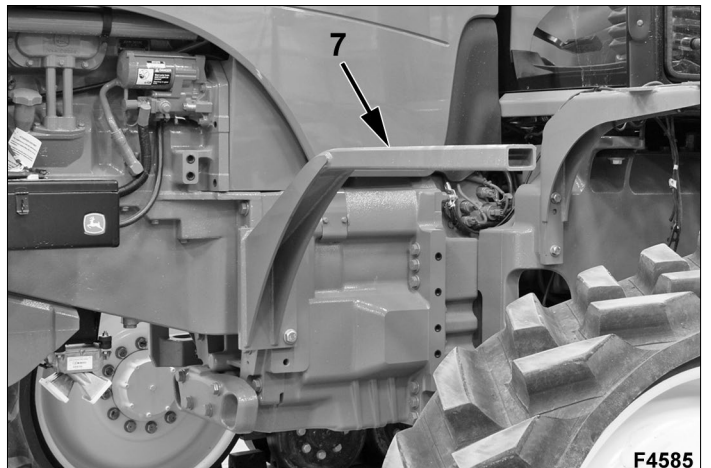

- Remove tool box (8) from bracket. Tool box bracket does not need to be removed.

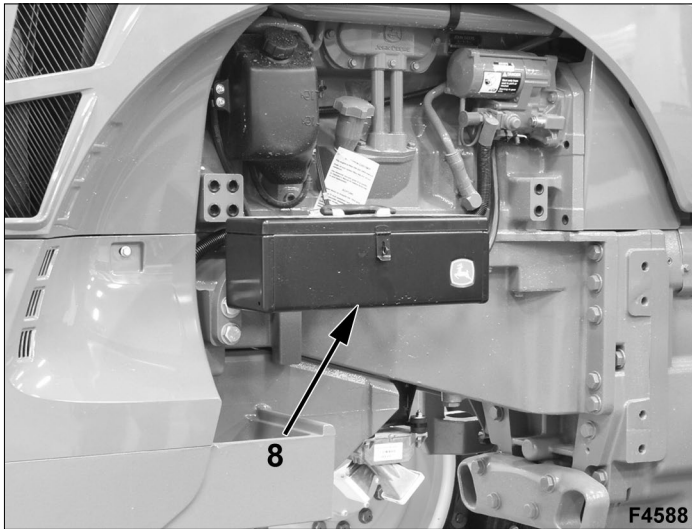

Remove Center Link Bracket And Radar

- Remove center link (1) and mounting bracket from right-hand side of tractor.

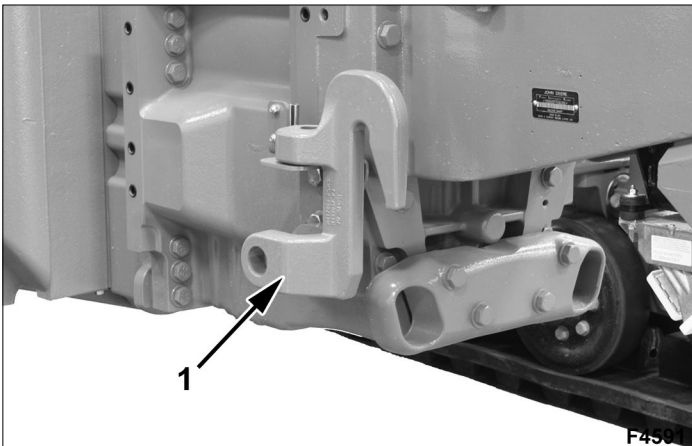

- Disconnect radar harness from radar (2). Remove radar from mounting bracket (3). Save hardware for reuse. Remove radar mounting bracket (3).

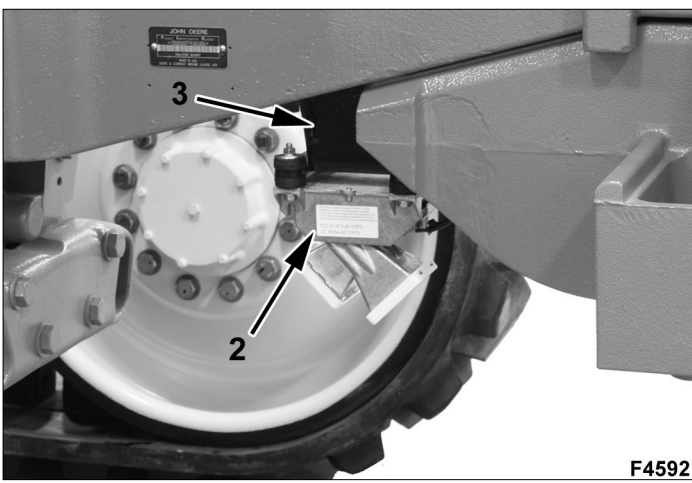

Install Rear Tank Supports

- Install right hand tank mount (1) with three M16 x 40mm GR8.8 bolts and three M16 flat washers. Repeat on left side using left hand tank mount, three M16 x 40mm GR8.8 bolts and three M16 flat washers.

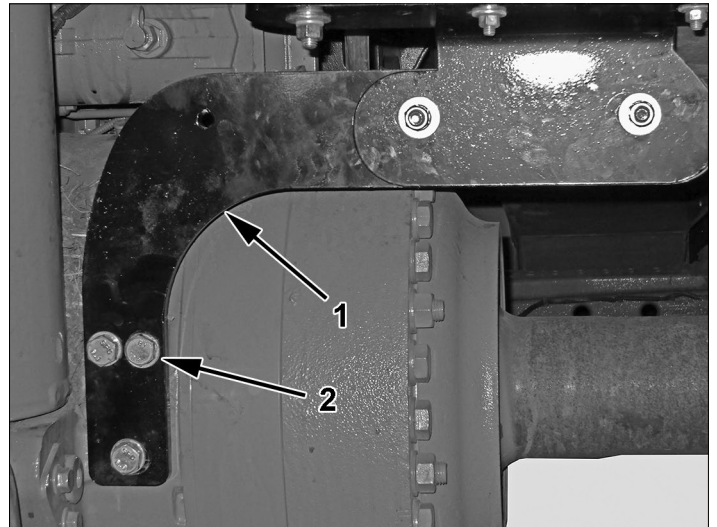

- Install tank support (3) with two $\frac{1}{2}$ X $1\frac{1}{2}$ " bolts (4), $\frac{1}{2}$ " washers and $\frac{1}{2}$ " nylock nuts. Do not fully tighten as bracket will need to be adjusted when tanks are installed later.

- Install rubber isolator (5) with three $\frac{1}{2}$ x $1\frac{1}{2}$ " bolts (6) and three $\frac{1}{2}$ " centerlock nuts. Snug bolts to slightly compress rubber. Repeat procedure for left hand side.

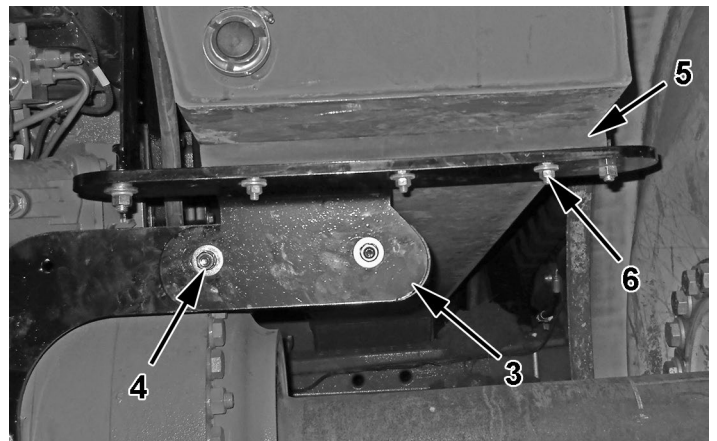

Note: For Ultra Wide Gauge tractor, brackets (1) and (3) are reversed.

Install Receiver Mounting Brackets

WARNING

Receiver mounting bracket weighs approximately 105 lbs. Use an appropriate lifting device to prevent injury.

1. Install left-side mounting bracket (1) to tractor with M20 x 60mm GR 10.9 bolts (2) and M20 flat washers. Refer to torque charts in this instruction for bolt torque values.

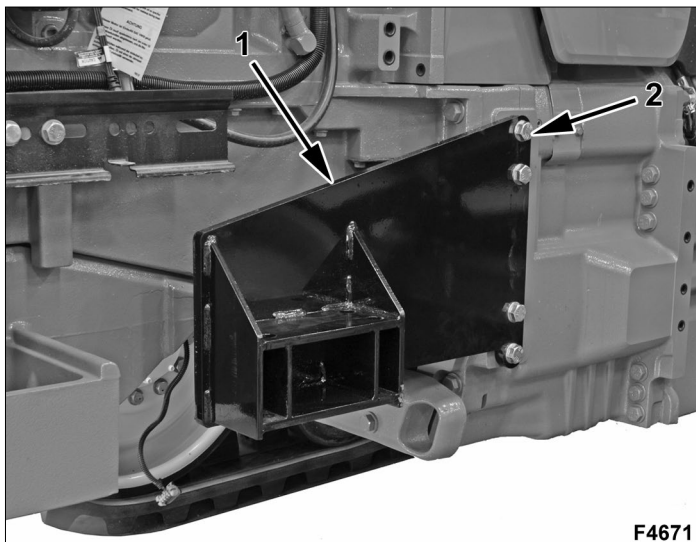

2. Install right-side mounting bracket (3) to tractor with M20 x 60mm GR 10.9 bolts (2) and M20 flat washers. Refer to torque charts in this instruction for bolt torque values.
3. Place rubber isolators (4) on top and bottom of bracket.
4. Place plate (5) on top of isolator and insert four 3/4 x 9" GR5 bolts (6) through plate and both isolators.
5. Repeat steps 3 and 4 for left-hand side receiver mounting bracket.

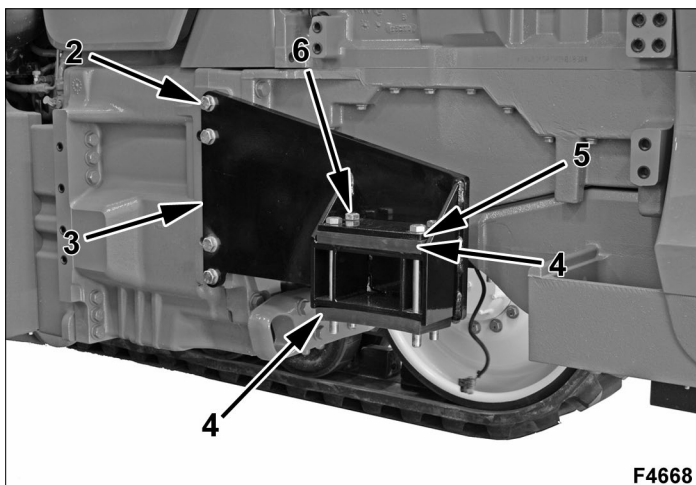

WARNING

Receiver mounting tube weighs approximately 105 lbs. Use an appropriate lifting device to prevent injury.

6. Raise receiver mounting tube (7) into position with radar bracket facing forward and install eight 3/4" centerlock nuts. Tighten all eight bolts equally so some bulge is seen on the rubber isolators.

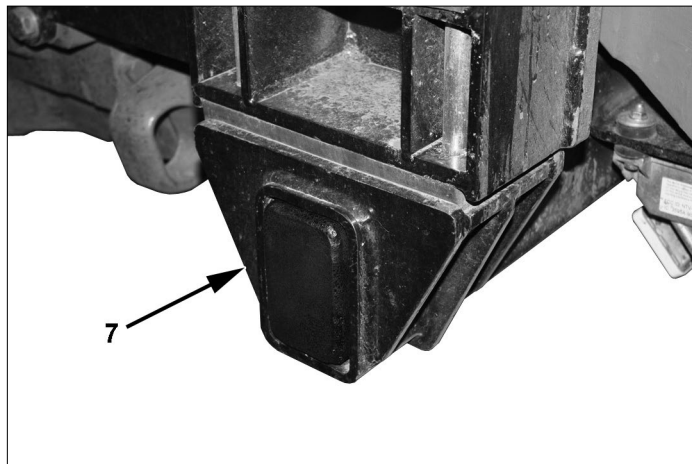

Install Setscrews

1. Install four setscrews (1) in receiver tube. Verify setscrews do not extend inside tubes.

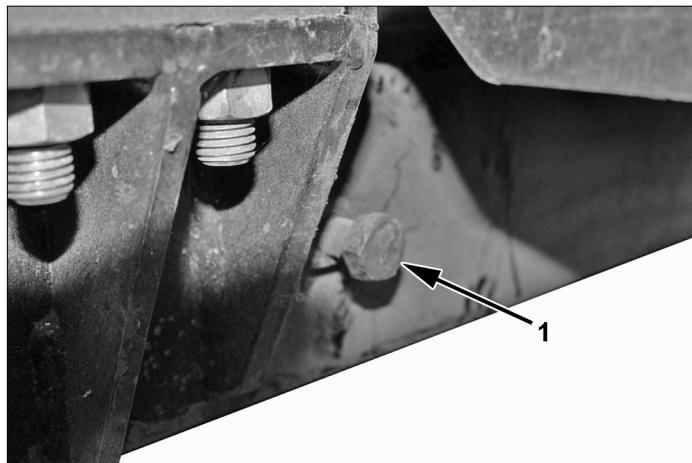

2. Install two setscrews (1) in each receiver on left and right-hand tanks. Verify setscrews do not extend inside tubes.

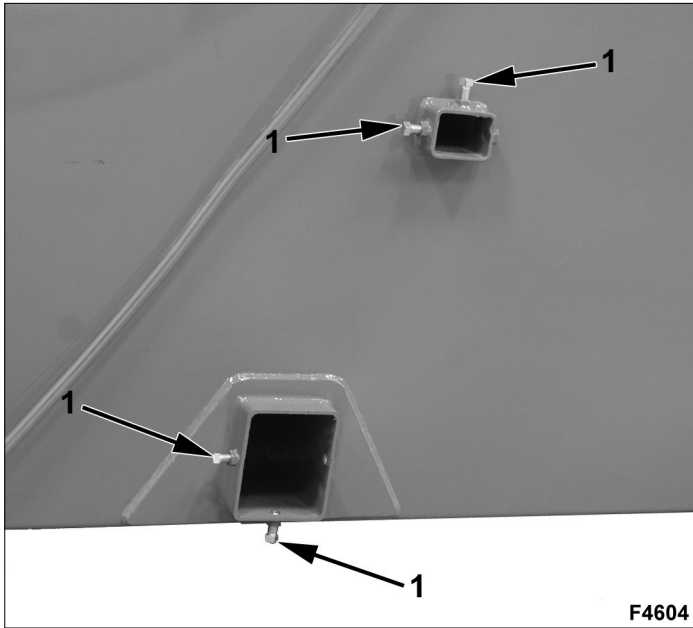

Install Radar

1. Attach radar (1) to mounting bracket (2) with existing hardware.

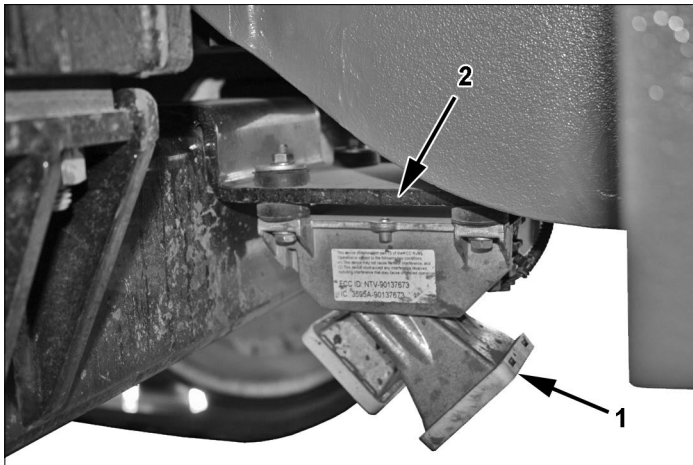

Install Tanks

⚠ WARNING

Each tank weighs approximately 1100 lbs.
Use an appropriate lifting device to prevent injury.

1. Connect an appropriate lifting device to left-hand tank.
Tank will balance when strap is 77" from center.

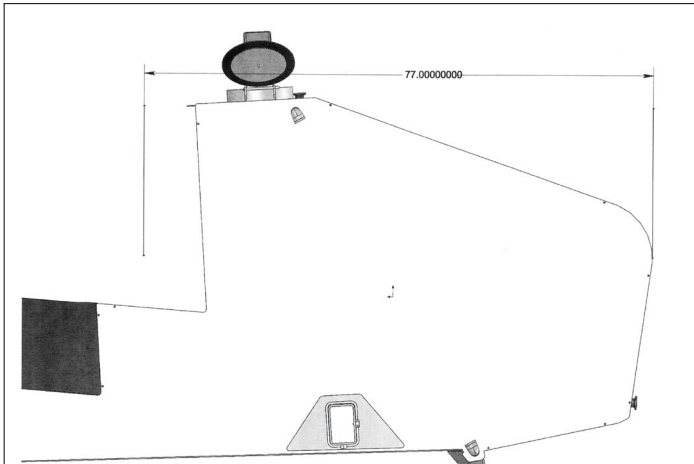

2. Connect an appropriate lifting device to right-hand tank.
Tank will balance when strap is 77" from center.

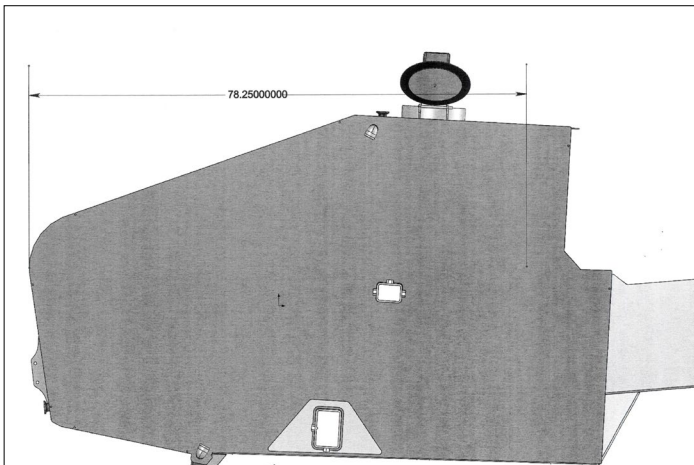

Typical Lifting Device

3. Raise tank and guide into position on rear support bracket (1).



4. Align tank receiver with front receiver and insert tube (2) through tank and into front receiver.

5. Verify that tube (2) does not extend past front receiver on right-hand side of tractor.

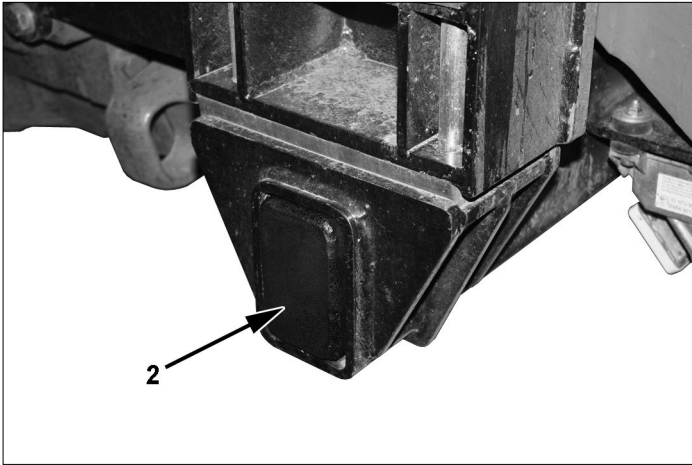

6. Install right-hand side tank using steps 1 and 2.
7. With right-hand tank (3) aligned with front receiver, push tube (2) through right-hand tank.

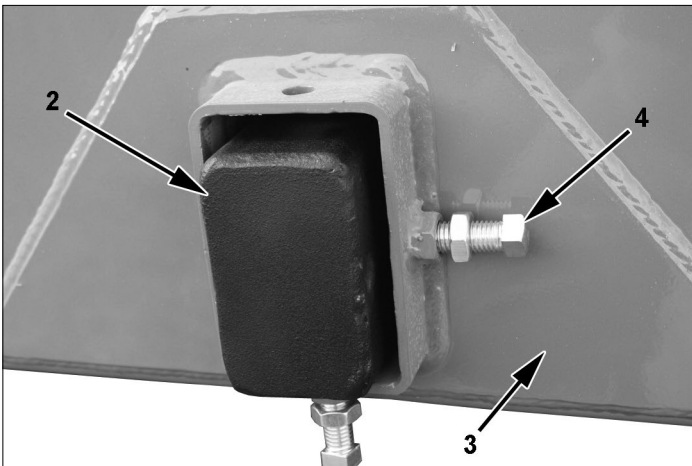

8. Push both tanks inward against front receiver and tighten eight setscrews (4) on front receiver and outside of both tanks. Refer to torque charts in this instruction for bolt torque values.
9. Disconnect lifting devices.

Install Straps And Nylon Protector

1. Position strap (1) into place and insert nylon web (2) between strap and tank. Insert studs on straps through holes in tank supports. Place two 1/2" washers and two nylock nuts on studs and tighten only enough to keep nylon web in place and tank from moving side to side. Now tighten the bolts (see Page 5, step 2) that hold the tank support to the tank mounts. Repeat procedure on left side.

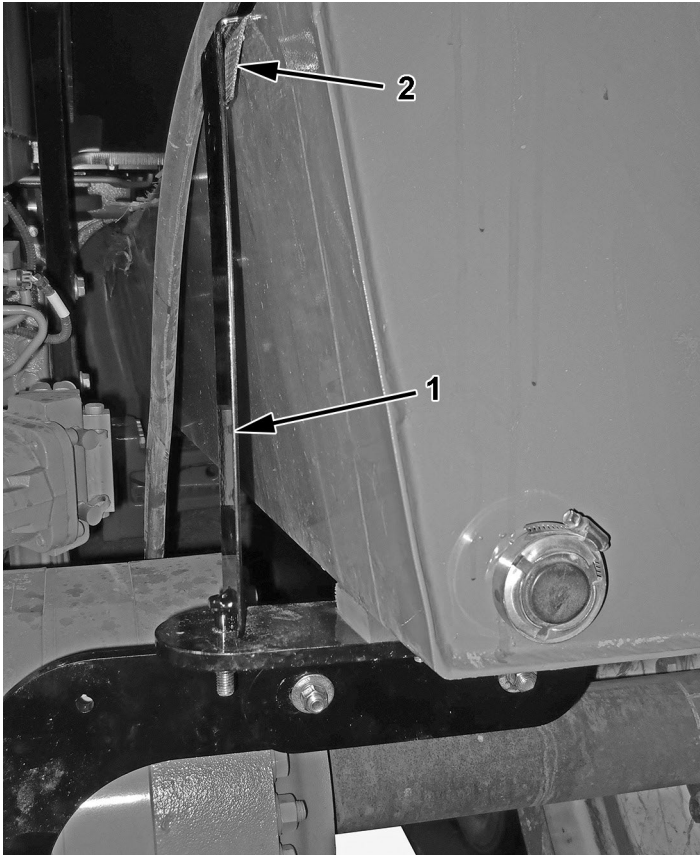

Install Windshield Washer Reservoir And DEF Fill Bracket

1. Install windshield washer reservoir with supplied hardware, remount windshield washer reservoir bracket and mount reservoir with hardware removed earlier.

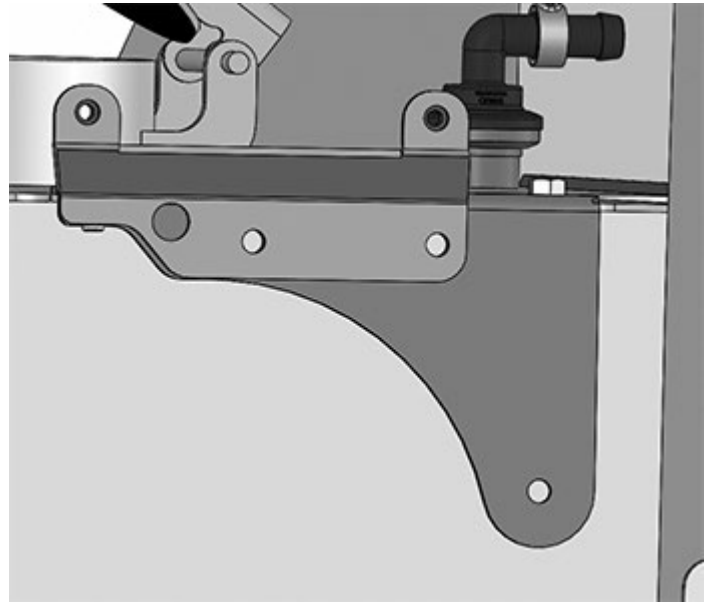

2. Bolt DEF Support bracket in place using two 592 carriage bolt 3/8 x 1 and two 769 3/8" nylock nuts. Reinstall DEF Fill with hardware removed earlier.

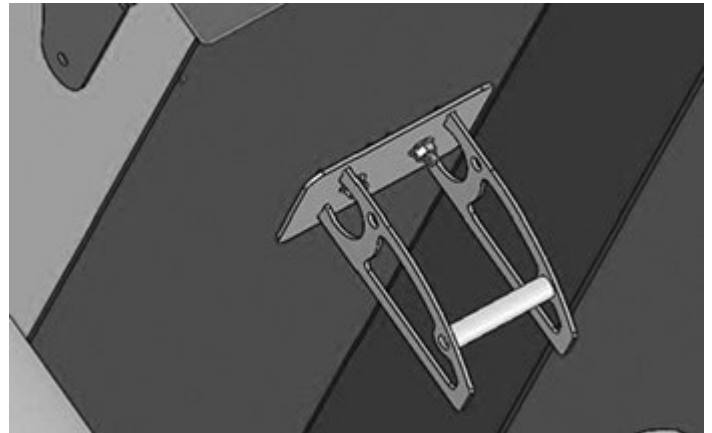

Install Step Assembly

1. Install top step bracket (1) with four 5/8 x 1.5" carriage bolts (2) and (3), and flange nuts. Refer to torque charts in this instruction for bolt torque values.

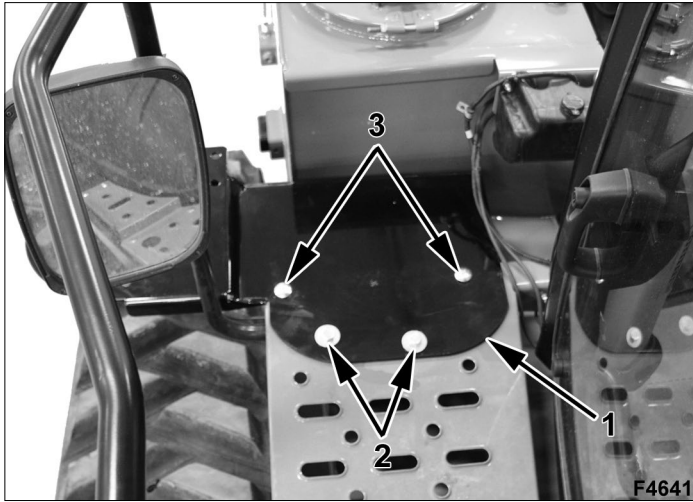

2. Remove six bolts (4) and existing top step. Install new top step and attach with six bolts previously removed. Refer to torque charts in this instruction for bolt torque values.



3. Install step support tube (6) as shown into receiver on left-hand tank. Do not tighten setscrews at this time.

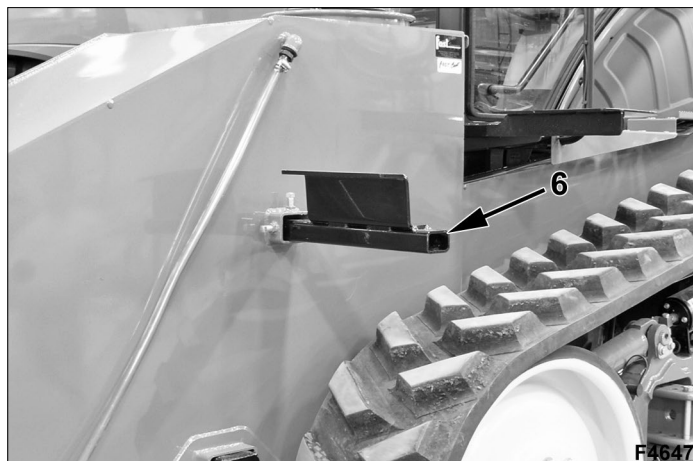

⚠ WARNING

Step assembly weighs approximately 300 lbs. Use an appropriate lifting device to remove step assembly.

4. Attach lifting device to step assembly.
5. Raise step assembly into position and attach to top bracket (1) with 5/8 x 1.5" carriage bolts (7) and 5/8" lock washers and nuts.

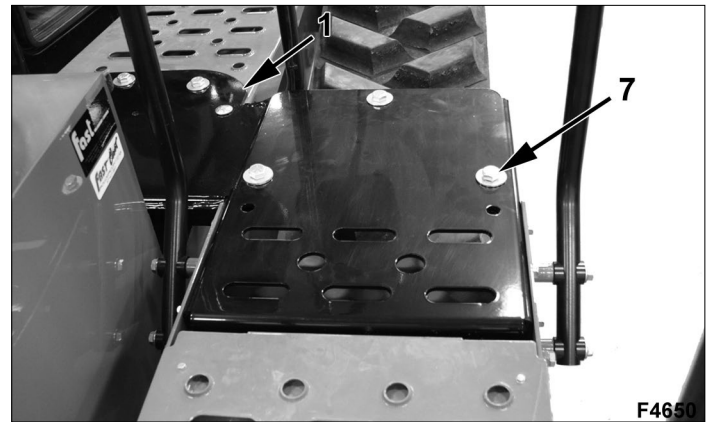

6. Attach to support tube with existing carriage bolts (8) and flange nuts.

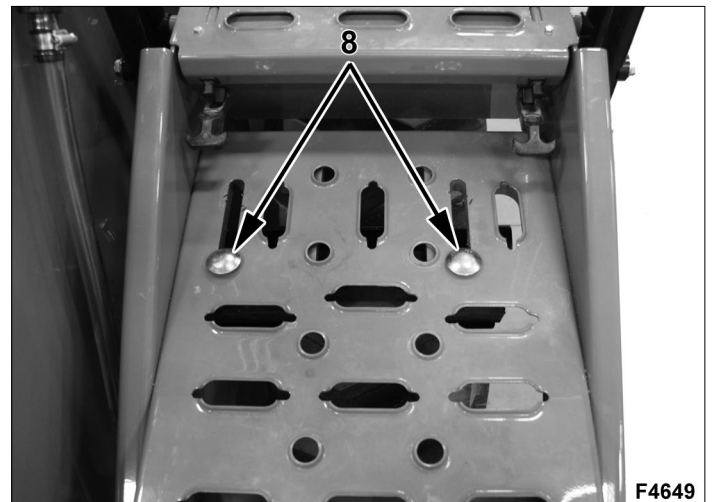

7. Adjust step and tighten all step hardware and setscrews. Refer to torque charts in this instruction for bolt torque values.

Tanks And Hardware

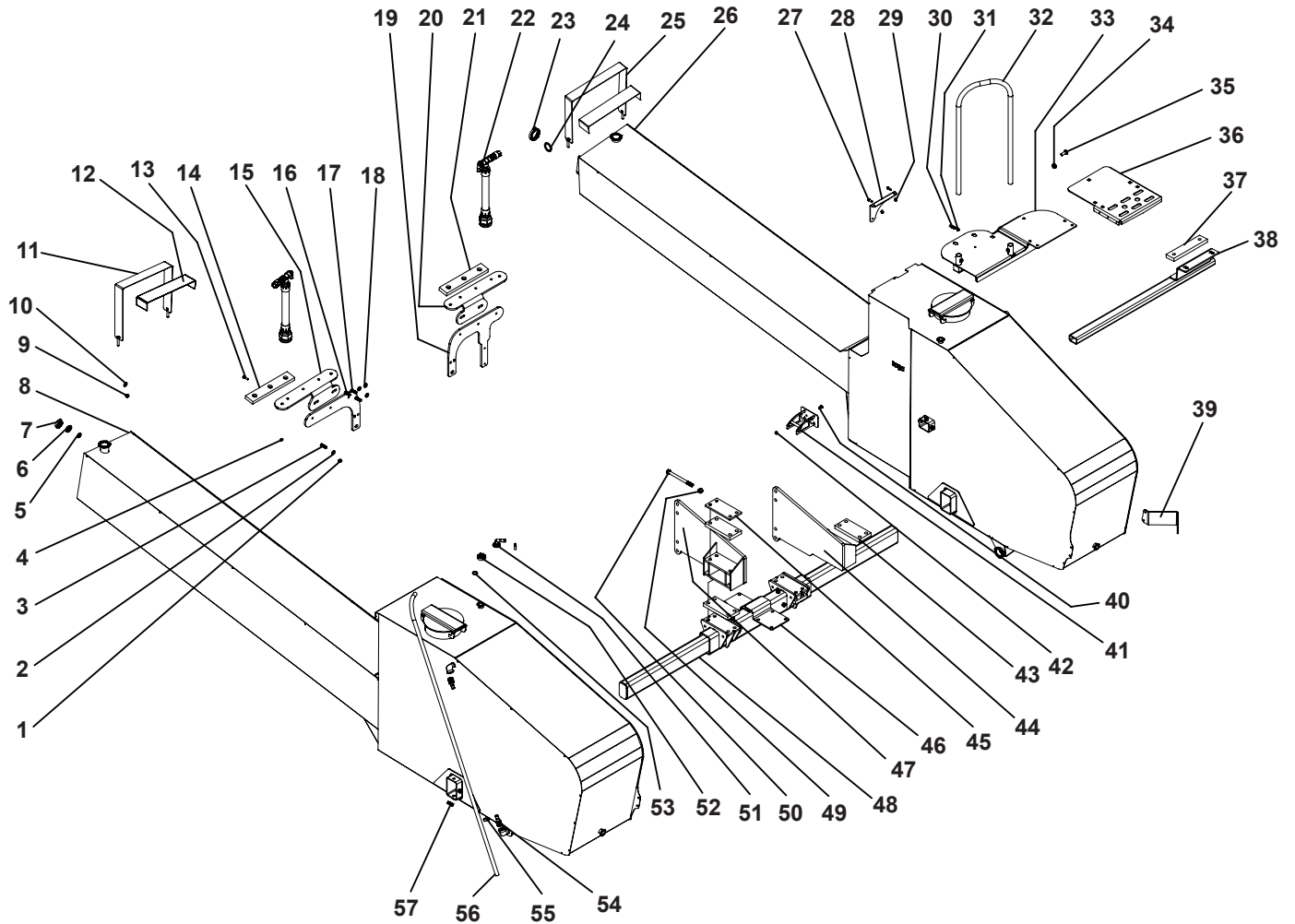

Item	Vendor Part #	Fast Part #	Description	Quantity
1		239	Nut Centerlock 1½" Zp	4
2		260	Washer ½" Zp	6
3		153	Bolt Hex Head ½ X 1-½ Zp Gr5	6
4		237	Nut Centerlock 3/8 ½" Zp	6
5	M100G	530068	Gasket Manifold 1"	4
6	FC100	540000	Clamp Manifold 1"	4
7	M100PLG	530070	Plug Manifold 1"	2
8		19900	Tank Track JD Right 4B	1
9		239	Nut Centerlock ½" Zp	4
10		260	Washer ½ Zp	4
11		19937	Strap Tie Down SS	1
12		19340	Web Nylon 4" Anti-Wear	2
13		129	Bolt Hex Head 3/8 X 1-½ Zp Gr5	6
14		14894	Isolator Rubber 4G	1
15		19337R	Tank Support Right Rear 4G	1
16		19326	Tank Mount Rear Right 4G	1
17		547	Bolt Hex Head 16mm X 40mm Gr. 8.8	6
18		551	Washer Lock 16mm	6
19		19327	Tank Mount Rear Left 4G	1
20		19337L	Tank Support Left Rear 4G	1
21		14894	Isolator Rubber 4G	1
22		10216	Riser Assembly	2
23		540002	Clamp Manifold 2" Full Port	2
24		530019	Gasket Manifold 2" Full Port	2
25		19337		
26		19901	Tank Track JD Left 4B	1
27		128	Bolt Hex Head 3/8 X 1 Gr5 Zp	2
28		19934	Bracket Windshield Washer Reservoir	1
29		769	Nut, Flange 3/8 Zp	2
30		779	Setscrew ½ X 1-½ Zp	2
31		223	Nut Hex , Jam ½ Zp	2
32		14932	Hand Rail	1
33		14935	Step Insert	1
34		590092	Bolt Carriage 5/8 X 1-½ Zp	3
35		772	Nut Whizlock 5/8"	3
36		14578	Jd Top Step	1
37		14547	Isolator Rubber Step	1
38		19918	Bracket Step	1
39		10206	Mount Quick Fill	1
40		592	Bolt Carriage 3/8 X 1	2
41		19920	Mount Def Fill	1
42		769	Nut, Flange 3/8 Zp	2
43		5333	Isolator Rubber Receiver Cross Tube	4
44		14898L	Mount Front Left 4G	1
45		5288	Plate Rubber Isolator	
46		14899	Receiver Cross Tube	1
47		14898R	Mount Front Right 4G	1
48		14554	Receiver Cross Tube	1
49		653	Nut Centerlock 3/4" Zp	8
50		590147	Bolt Hex Head 3/4 X 9 Zp Gr5	8
51	M100075BRB90	530060	1 Inch Manifold X 3/4 Inch Elbow	2
52	FC100	540000	Manifold Clamp 1"	2
53	100G	530068	Manifold Gasket	2
54	HB100-075	530043	Hose Barb 1" Npt X 3/4 HB	4
55	64012H	540013	Clamp Hose 3/4"	6
56	15007008	510006	Hose Vinyl 3/4" X Specify Feet	2
57		590165	Setscrew 5/8 X 1-½" ZP	14

Plumbing

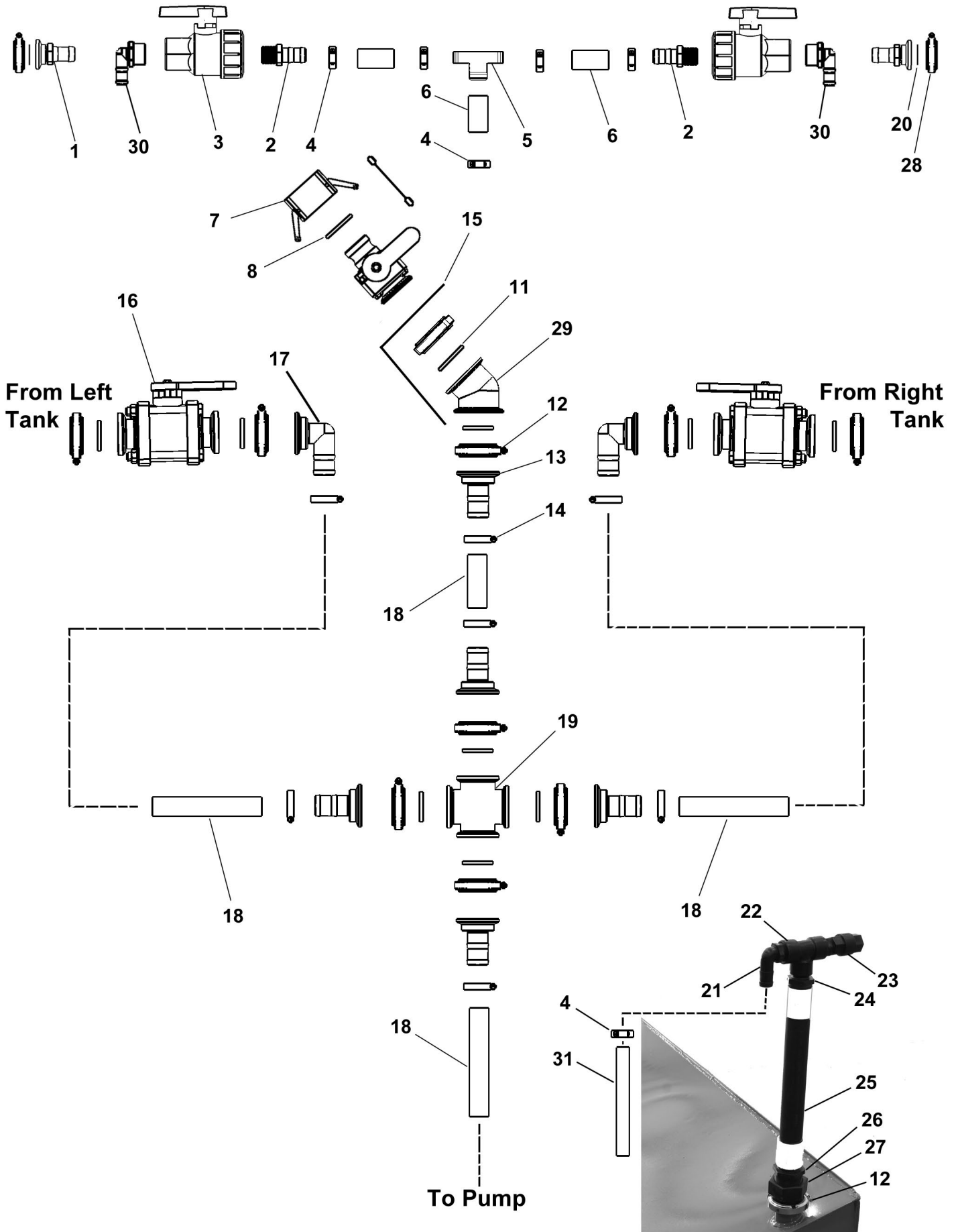

Item	Vendor Part #	Fast Part #	Description	Quantity
1	M100MPT	530069	1" Manifold x 1" MPT	2
2	HB100	530041	1" MPT x 1" Hose Barb	2
3	UV100FP	500009	Valve, 1"	2
4	64016H	540014	Clamp, 1"	6
5	HBT100	530056	1" Hose Barb Tee	1
6	1BH200	510016	1" Hose, Cut To Fit	1
7	300CAP	530017	Cap, 2"	1
8	200G	530019	Gasket (Part of 530017)	
9	HN-79-12	530179	Cable Lanyard	1
10	MVSF220FP	530128	Manifold Valve 2" Full Port x Male Adapter	1
11	200G	530019	Gasket, 2"	11
12	FC220	540002	Clamp, 2"	11
13	M220200BRB	530103	Flanged Hose Barb, 2"	5
14	TC-231	540007	T-Bolt Clamp 2" Hose	8
15		10206	Mount, Quick Fill Valve	1
16	MV220FP	500006	Valve, 2"	2
17	M220BRB90	530104	Flanged Hose Barb 90°, 2"	2
18	12012800	510002	2" Hose, Cut To Fit	
19	M220CR	530107	Full Port Flanged Cross, 2"	1
20	M100G	530068	Gasket 1"	4
21	HB100-90	530044	1" MPT x 1" Hose Barb 90	2
22	TEE100	530157	1" Poly Tee	2
23	1870290	500014	3/4" Check Valve	2
24	RN150-100	530149	Poly Reducing Nipple	2
25		102107	JD Riser Assembly 13" Tube	2
26	RN200-150	530249	2" x 1-1/2" Reducing Nipple	2
27	M220FPT	530243	2" FP Manifold x 2" FPT	2
28	FC100	540000	Clamp 1"	2
29	M220CPG45	530105	2" x 2" 45° Full Port Coupling	2
30	SL100-90	530152	1" Street Elbow	2
31		510006	Hose Vinyl 1" x 48"	2

SAE Torque-Tension Values

Bolt Size	Grade 2		Grade 5		Grade 8	
	Dry lb-ft (N•m)	Lubricated lb-ft (N•m)	Dry lb-ft (N•m)	Lubricated lb-ft (N•m)	Dry lb-ft (N•m)	Lubricated lb-ft (N•m)
1/4-28	6 (9)	5 (6)	10 (13)	7 (10)	14 (19)	10 (14)
1/4-20	6 (8)	4 (6)	8 (11)	6 (9)	12 (16)	9 (12)
5/16-24	13 (17)	9 (13)	19 (23)	14 (20)	27 (37)	20 (28)
5/16-18	11 (15)	8 (11)	17 (24)	12 (18)	25 (33)	18 (25)
3/8-24	23 (31)	17 (23)	35 (48)	26 (36)	49 (59)	37 (44)
3/8-16	20 (27)	15 (20)	31 (42)	23 (31)	44 (59)	32 (44)
7/16-20	36 (48)	27 (36)	55 (75)	41 (56)	78 (106)	58 (79)
7/16-14	32 (43)	24 (33)	49 (67)	37 (50)	70 (95)	52 (71)
1/2-20	55 (75)	41 (56)	85 (115)	64 (86)	120 (163)	90 (122)
1/2-13	49 (66)	37 (50)	75 (102)	57 (77)	106 (144)	80 (108)
9/16-18	78 (106)	59 (80)	121 (164)	91 (123)	171 (232)	128 (174)
9/16-12	70 (95)	53 (72)	109 (148)	82 (111)	154 (209)	115 (156)
5/8-18	110 (149)	82 (111)	170 (231)	127 (172)	240 (326)	180 (244)
5/8-11	97 (132)	73 (99)	150 (204)	113 (153)	212 (288)	159 (216)
3/4-16	192 (261)	144 (195)	297 (403)	223 (303)	420 (570)	315 (427)
3/4-10	172 (233)	129 (175)	269 (365)	201 (273)	376 (510)	282 (383)
1-12	--	--	704 (955)	528 (716)	995 (1350)	746 (1012)
1-8	--	--	644 (874)	483 (655)	909 (1233)	681 (924)

Metric Torque-Tension Values

Bolt Size	Class 4.8		Class 8.8		Class 10.9		Class 12.9	
	Dry lb-ft (N•m)	Lubricated lb-ft (N•m)	Dry lb-ft (N•m)	Lubricated lb-ft (N•m)	Dry lb-ft (N•m)	Lubricated lb-ft (N•m)	Dry lb-ft (N•m)	Lubricated lb-ft (N•m)
M6	4.7 (3.5)	6 (4.5)	8.9 (6.5)	11.3 (8.5)	13 (9.5)	16.5 (12)	15.5 (11.5)	19.5 (14.5)
M8	11.5 (8.5)	14.5 (10.5)	22 (16)	27.5 (20)	32 (23.5)	40 (29.5)	37 (27.5)	47 (35)
M10	23 (17)	29 (21)	43 (32)	55 (40)	63 (46)	80 (59)	75 (55)	95 (70)
M12	40 (29.5)	50 (37)	75 (55)	95 (70)	110 (80)	140 (105)	130 (95)	165 (120)
M14	63 (46)	80 (59)	120 (88)	150 (110)	175 (130)	220 (165)	205 (150)	260 (190)
M16	100 (74)	125 (92)	190 (140)	240 (175)	275 (200)	350 (255)	320 (235)	400 (300)
M18	135 (100)	170 (125)	265 (195)	330 (245)	375 (275)	475 (350)	440 (325)	560 (410)
M20	190 (140)	245 (180)	375 (275)	475 (350)	530 (390)	675 (500)	625 (460)	790 (580)
M22	265 (195)	330 (245)	510 (375)	650 (480)	725 (535)	920 (680)	850 (625)	1080 (800)
M24	330 (245)	425 (315)	650 (480)	820 (600)	920 (680)	1150 (850)	1080(800)	1350(1000)



Fast Sprayers
54859 County Road 44
Mountain Lake, MN 56159
1-800-772-9279 Toll Free
1-507-427-3861 Voice
1-507-427-3030 Fax